

# Whatman Klari-Flex™

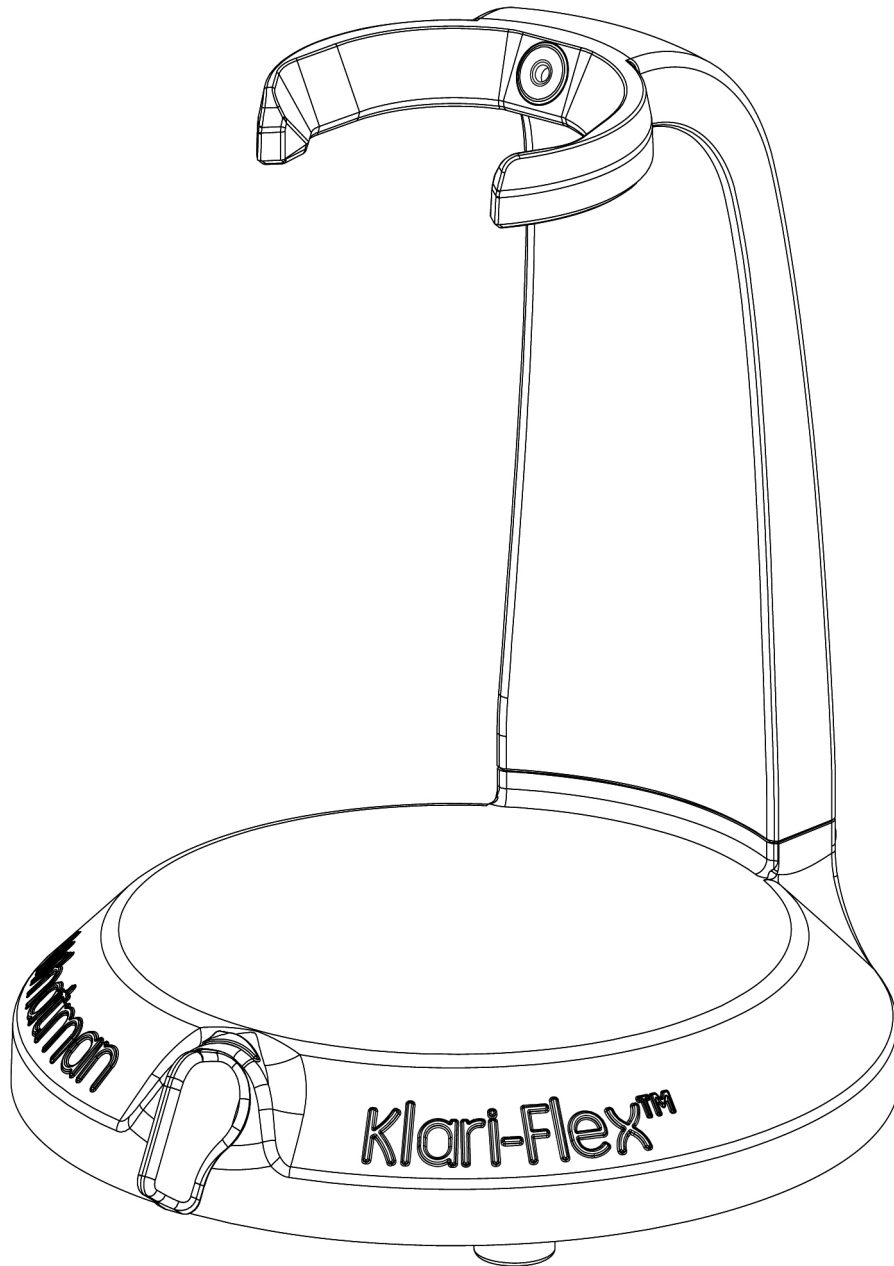

# Whatman Klari-Flex™

## 1. Introduction:

The **Whatman Klari-Flex** filtration system has been designed for use in laboratory environments. The materials of construction are compatible with common disinfectants and sanitizing agents. The smooth contoured design is readily cleaned by spraying or applying a disinfectant and wiping as required.

Under normal operating conditions, fluids should not come in contact with the internal plumbing of the **Whatman Klari-Flex** pedestal or cradle ring stand. In the event fluids do come in contact with the internal plumbing, the following procedure can be followed to decontaminate the system.

## 2. Preparing the Sanitizing Agent:

- a) The following sanitizing agents can be used:
- Iodophors (follow manufacturers recommended dilution)
  - Alcohols (effective dilution is 70-85%)
  - Commercially available disinfectants

NOTE: Use of **hypochlorite** (bleach) is not recommended. Prolonged exposure to **hypochlorite** may cause corrosion to internal stainless steel components. Adequate water rinsing is necessary if **hypochlorite** solution is used.

- b) Prepare 500mL of sanitizing agent in a proper flask or container following manufacturer's recommendation.

## 3. Prepare the pedestal or cradle ring stand for sanitation (refer to illustration below)

- a) 1) Inserting a blunt point into the hole and gently remove rubber gasket from the pedestal or cradle ring stand.  
2) Insert vacuum tube adaptor into main vacuum port.

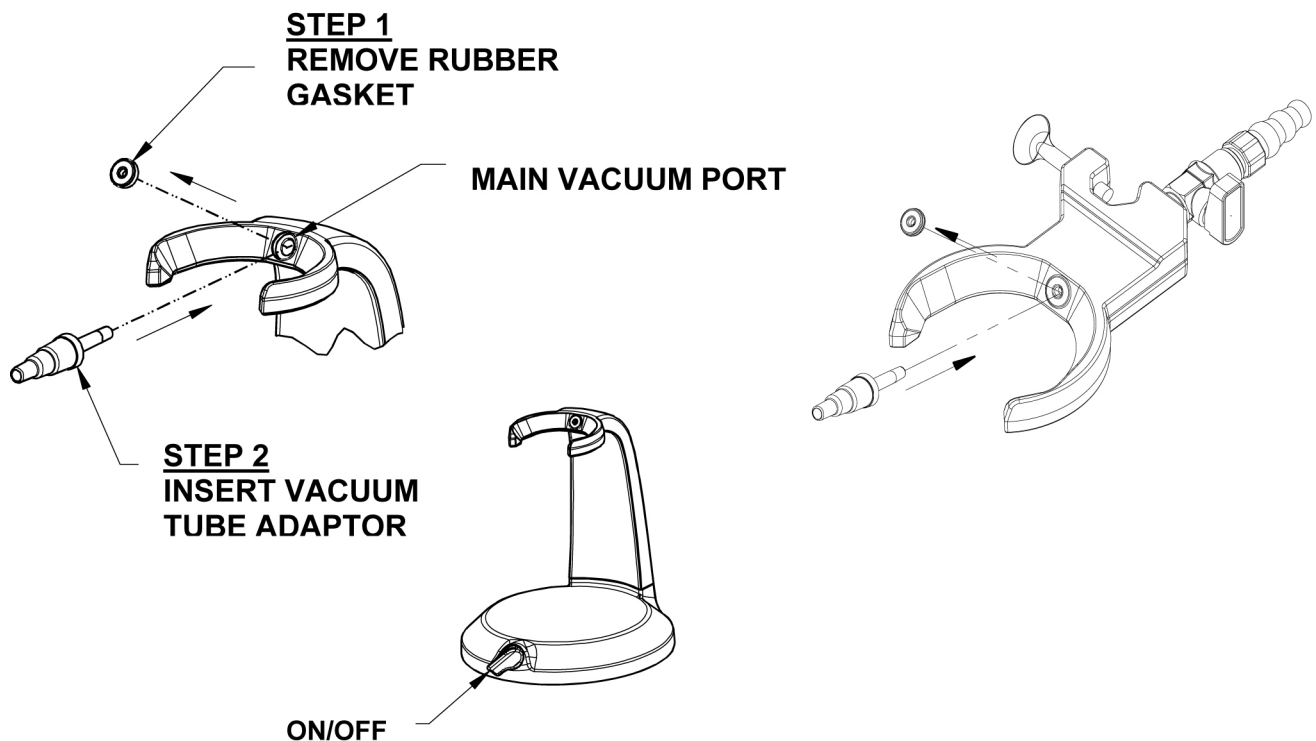

- b) Assembly vacuum trap for accepting waste solution between vacuum pump and pedestal or cradle ring stand.

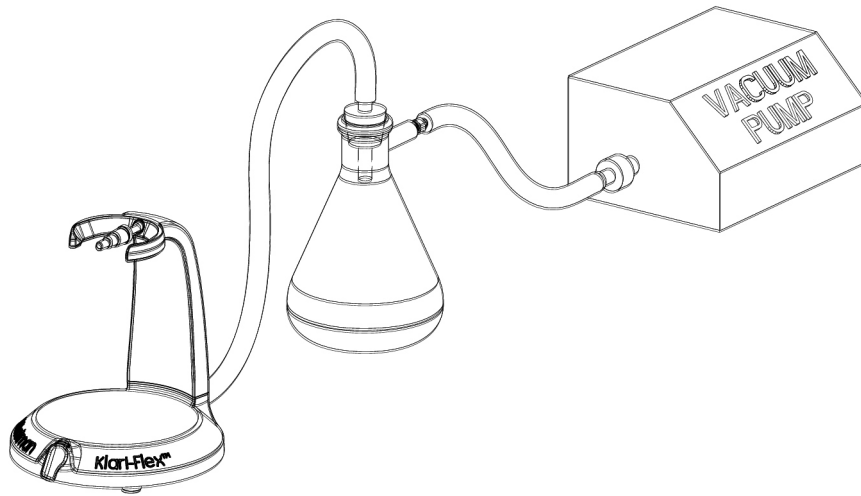

- c) Attach feed tube to adaptor and place open end into vessel containing sanitizing agent.

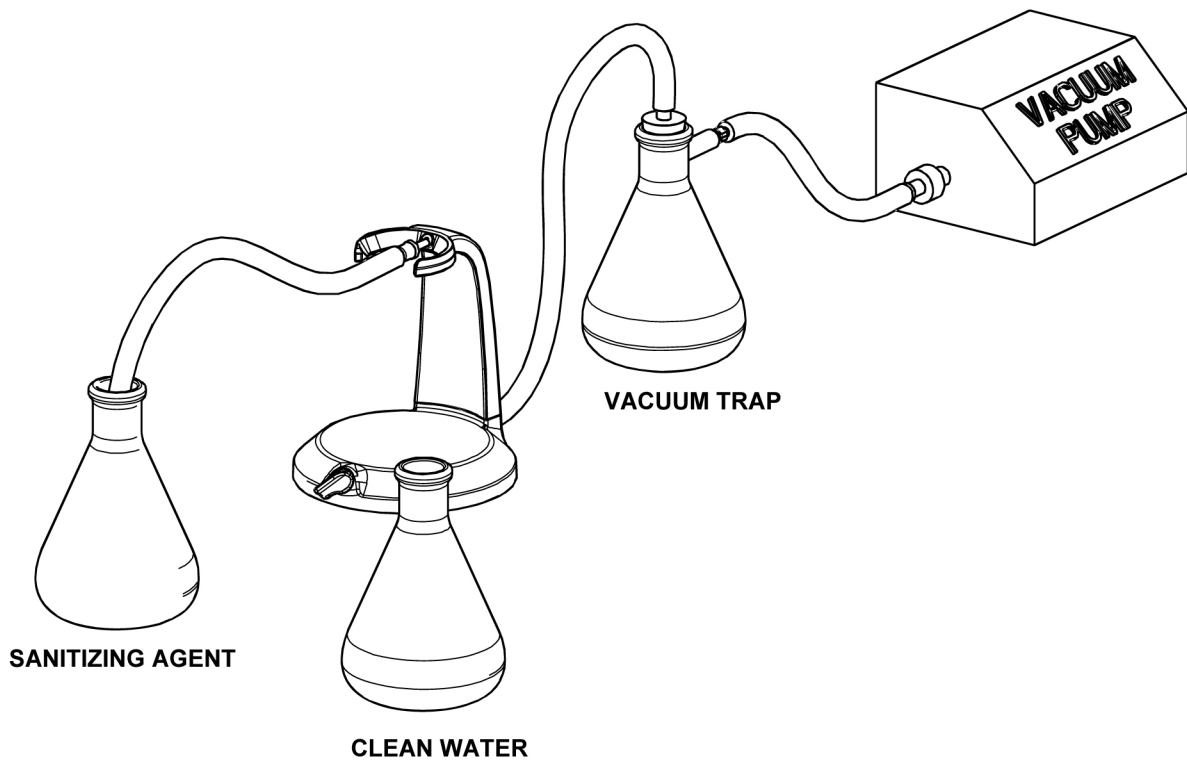

4. Sanitize pedestal or cradle ring stand
  - a) Turn on the vacuum system.
  - b) Draw the 500mL of solution through the pedestal or cradle ring stand and into the vacuum trap.
  - c) Allow stand to set for 30 minutes prior to rinsing.

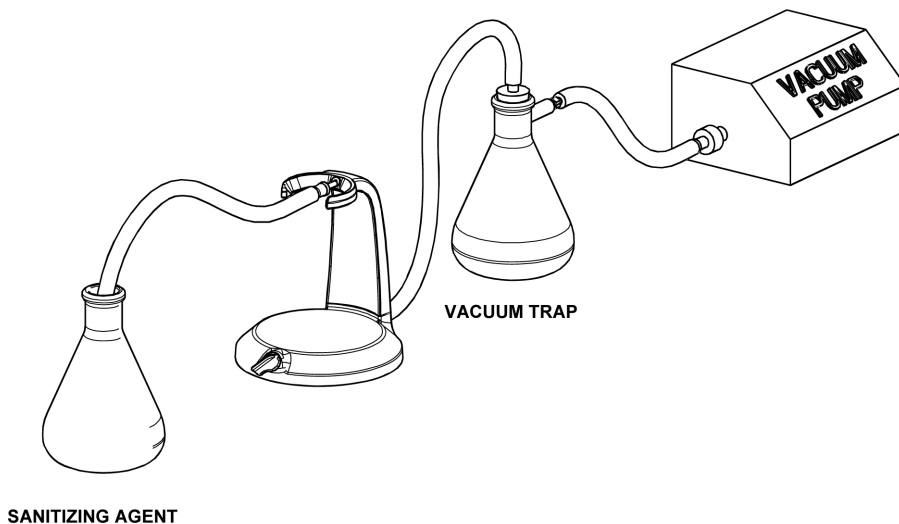

- d) Remove feed tubing from stand and place into clean water container.
- e) Draw approximately 500mL's of distilled water through the pedestal or cradle ring stand and into vacuum trap to rinse the system.

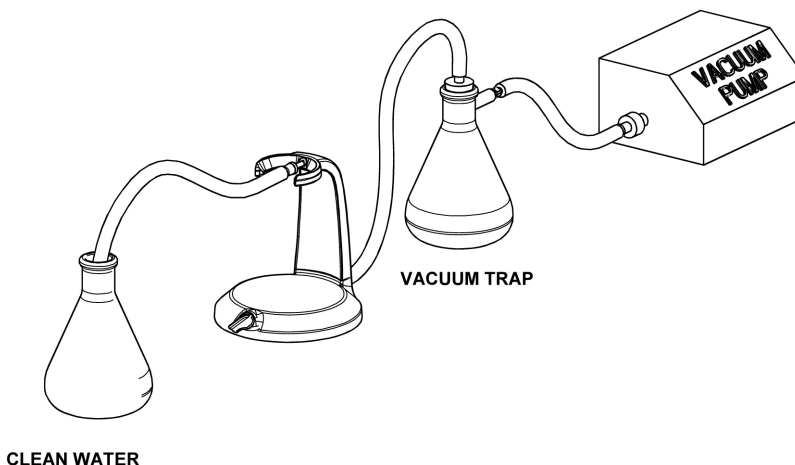

[www.gelifesciences.com/whatman](http://www.gelifesciences.com/whatman)

GE Healthcare Bio-Sciences Corp.  
800 Centennial Avenue  
Piscataway, NJ 08855-1327 USA

GE, imagination at work and GE monogram are trademarks of General Electric Company.

Whatman and Klari-Flex is a trademark of GE Healthcare companies.

All third party trademarks are the property of their respective owners.

© 2009 General Electric Company - All rights reserved.

First published August 2009.

All goods and services are sold subject to the terms and conditions of sale of the company within GE Healthcare which supplies them. A copy of these terms and conditions is available on request. Contact your local GE Healthcare Representative for the most current information.

GE Healthcare Bio-Sciences AB  
Björkgatan 30  
751 84 Uppsala  
Sweden

GE Healthcare UK Limited  
Amersham Place  
Little Chalfont  
Buckinghamshire, HP7 9NA  
UK

GE Healthcare Europe, GmbH  
Munzinger Strasse 5, D-79111 Freiburg  
Germany

GE Healthcare Bio-Sciences KK  
Sanken Bldg., 3-25-1, Hyakunincho  
Shinjuku-ku, Tokyo 169-0073  
Japan



imagination at work